

A259 Active Travel Scheme Hove & Portslade

Monday 14 July 2025



**Brighton & Hove
City Council**

Location overview

Scheme 2

(Wharf Rd to Western City Boundary)

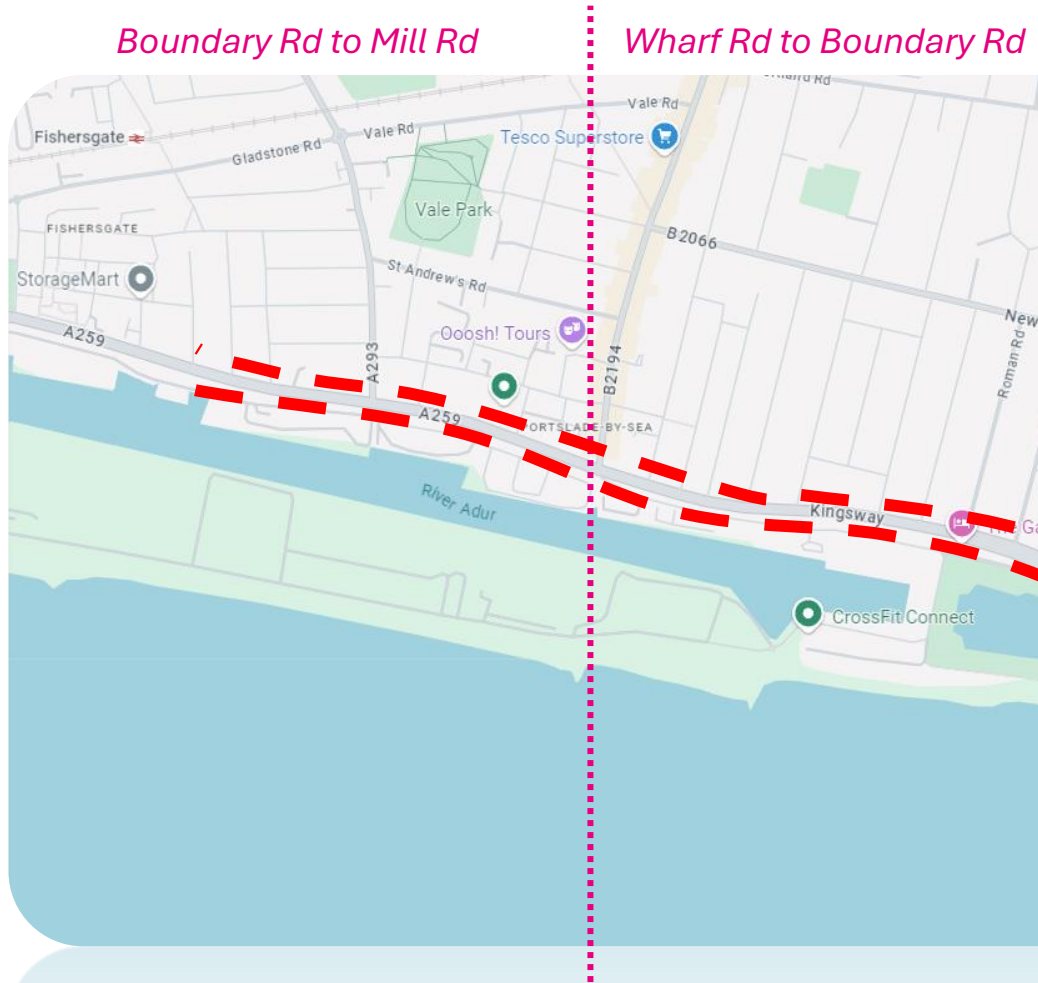

Scheme 1

(Fourth Ave – Wharf Rd)

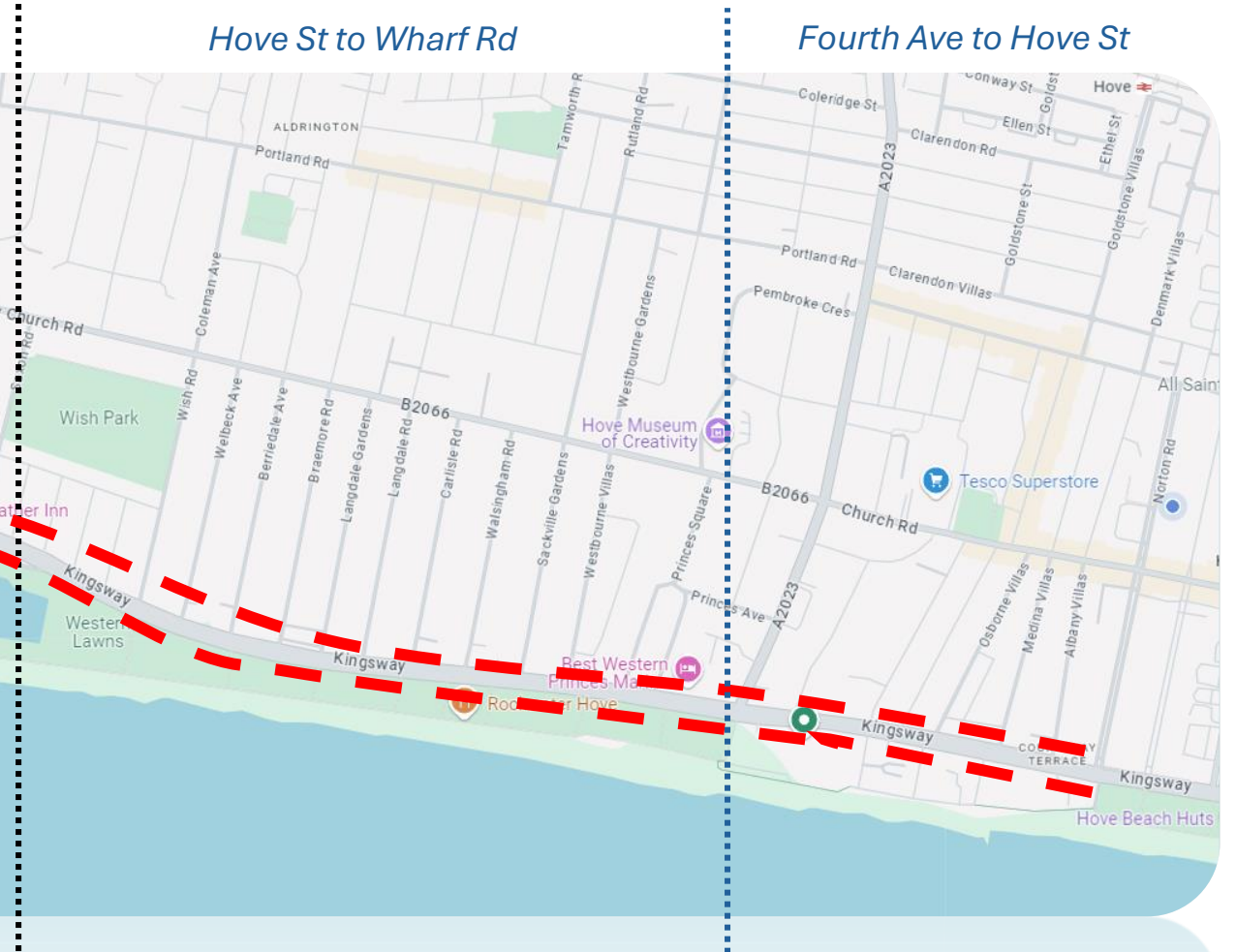

Examples from other places of relevant design features



Junctions

Hove Street junction

Current photo



New design

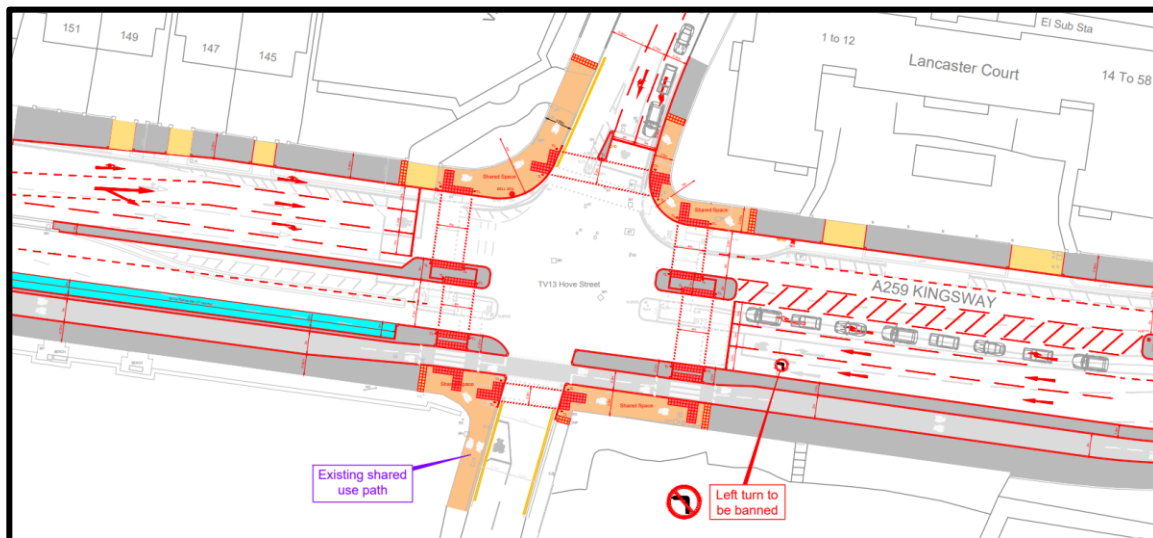

Wharf Road Junction



Current photo



New design

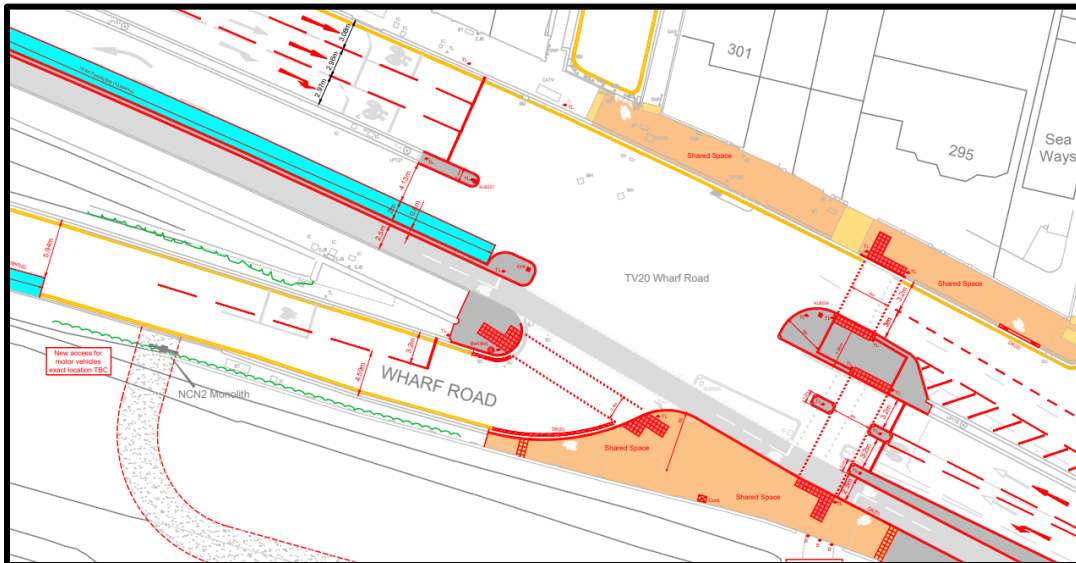

Boundary Road Junction



Current photo



Proposed
Bus Stop



New design

Church Road Junction



Current photo

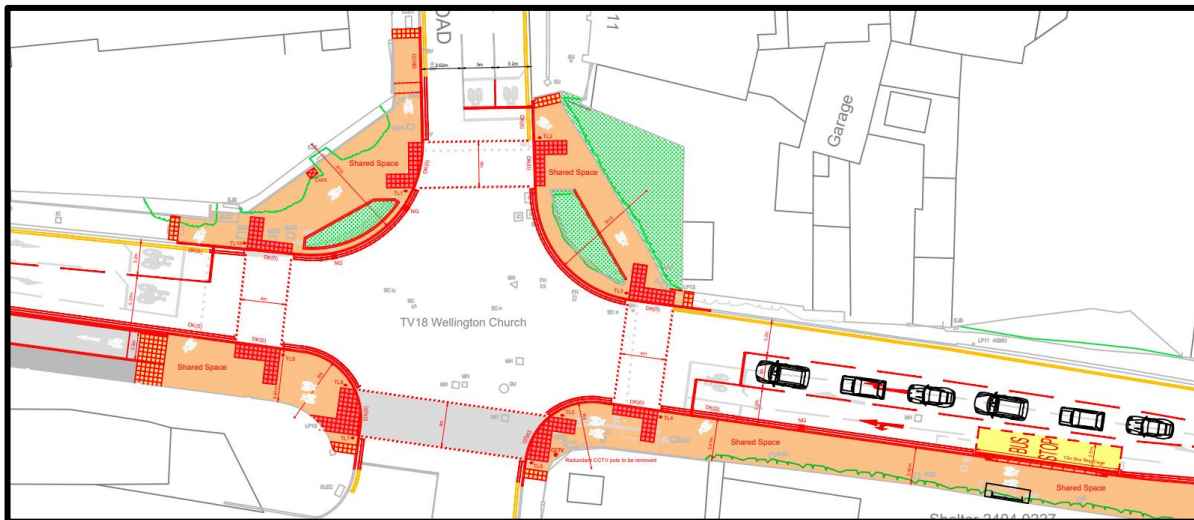

New design

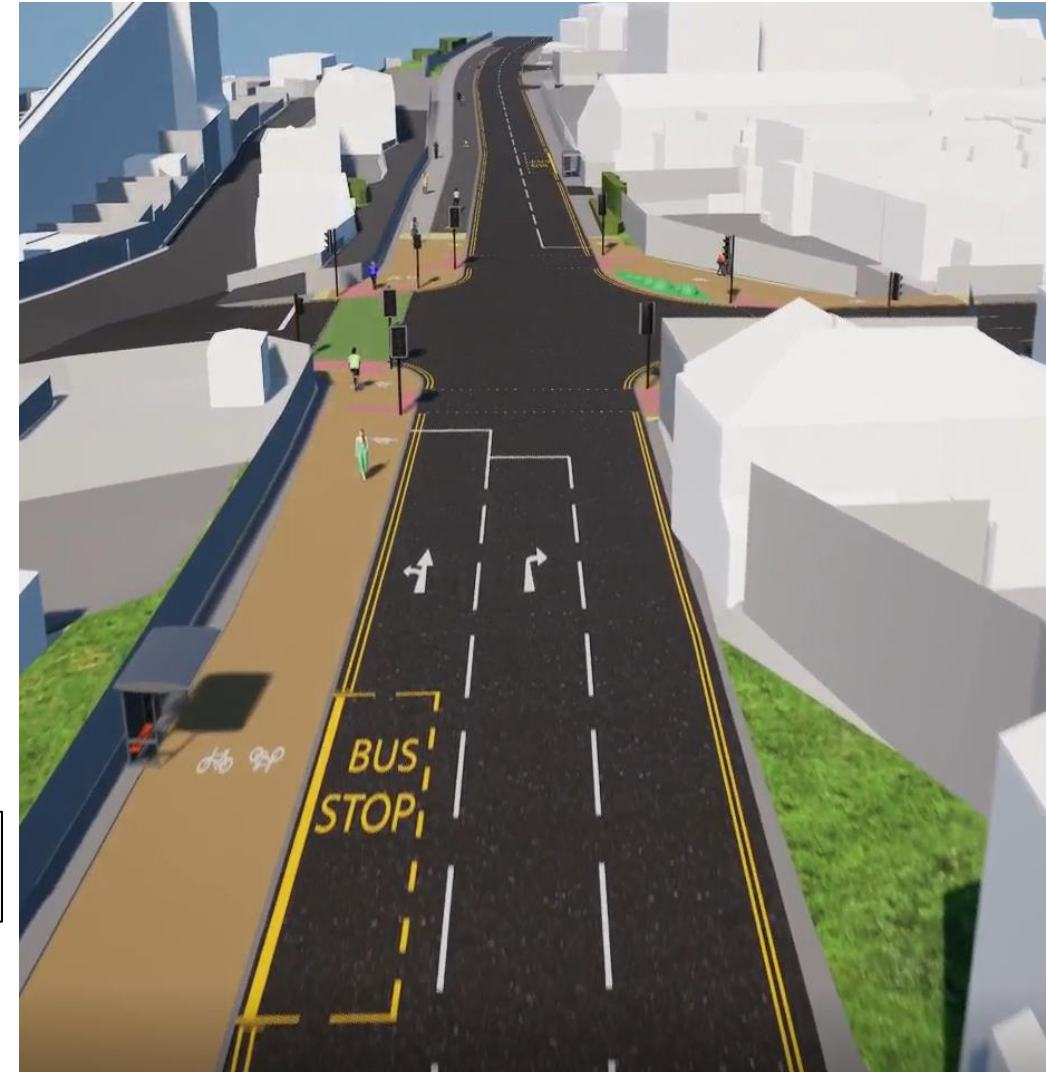

**Some other key
scheme areas**

Victoria Terrace



Current photo



New design



St Aubyns Crossing



Current photo

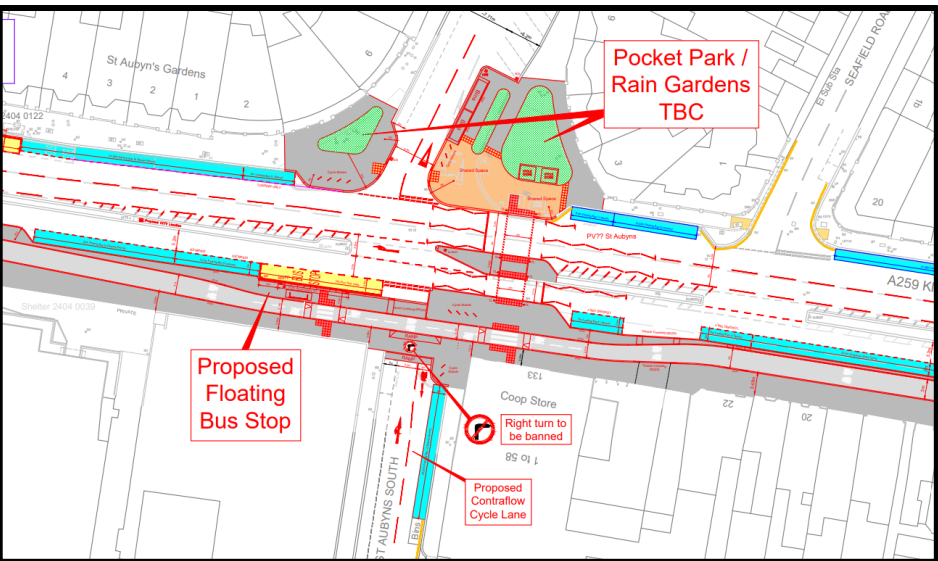

New design



Hove Lagoon / Wish Road Crossing



Current photo

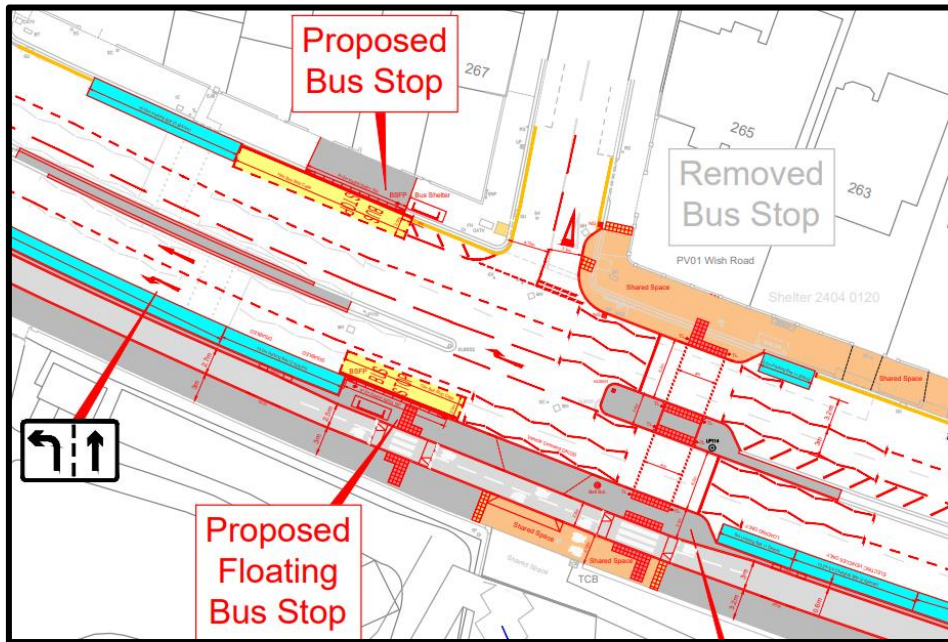

New design



A259 Active Travel Scheme Summary



2 miles of bi-directional segregated cycle track



3 new signalised crossing points



Improvements & upgrades to existing pedestrian crossing facilities

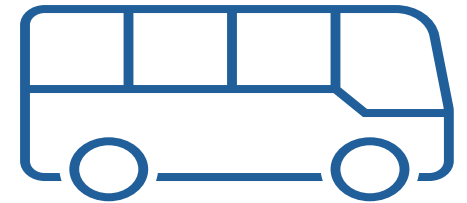

Bus Stop Improvements



Safety upgrades to 4 key junctions along the corridor



Footway widening through reallocation of space



Various improved side road crossing facilities for pedestrians & cyclists



Key principles followed and LTN 1/20 compliant

Next steps

[A259 Hove to Portslade active travel scheme consultation link](#)

Next Steps

- ❑ Public consultation – 16 June – 27 July 2025
- ❑ Consultation analysis & design alterations – Aug-Sept 2025
- ❑ Cabinet decision post-consultation - Oct 2025
- ❑ Detailed design complete - end Dec 2025
- ❑ Traffic Regulation Order consultations (TROs) – Jan-Feb 2026
- ❑ Contractor procurement – Spring 2026
- ❑ Construction begin - Spring / Summer 2026



Hove St
junction
re-design

Questions and discussion

